

## Outdoor &amp; Industrial modules

Made in Italy

CULUS EN 15

UP TO  
223  
lm/W>100.000 h  
@ tc=85 °C

ENERGY



SLM70/50G4

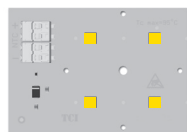

SLM121/50G8



SLM172/50G12



SLM224/50G16

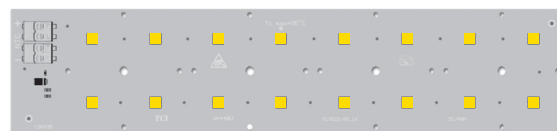

3.1

OUTDOOR &amp; INDUSTRIAL LIGHTING

## CRI

>70  
>80 available online  
>90 on request - su richiestaAvailable (CCT)  
colour temperature3000 K  
4000 K  
5000 K2700 K on request - su richiesta  
3500 K on request - su richiesta  
5700 K on request - su richiesta  
6500 K on request - su richiesta

## Beam angle

120 °

## Ambient temperature

ta: -40...+55 °C

(Only for tc ≤ 85 °C)

## Module temperature

tc: 85 °C

## Absolute maximum

operating current:  
1600 mA

## Standards compliance

CSA-C22.2 no.250  
EN 55015  
EN 62031  
EN 62471  
IEC TR 62778  
UL 8750

Article Articolo	Code Codice	CCT K	Current mA	Flux tc 25°C lm	Flux tc 65°C lm	Power tc 65°C W	Efficacy tc 25°C lm/W	Efficacy tc 65°C lm/W	Vmin. tc 25°C @Imin	Vmax. tc 25°C @Imax
SLM70/50G4	128901/727CV	2700	350	792	744	3,8	207	198	11	12,6
			700	1537	1444	8	192	183		
			1050	2236	2100	12	180	171		
	128901/730CV	3000	350	804	755	3,8	210	201		
			700	1560	1465	8	195	186		
			1050	2269	2130	12	182	174		
	128901/740CV	4000	350	851	799	3,8	223	212		
			700	1650	1550	8	206	196		
			1050	2401	2254	12	193	184		
	128901/750CV	5000	350	839	788	3,8	220	209		
			700	1628	1529	8	203	194		
			1050	2368	2223	12	190	181		
SLM121/50G8	128902/727CV	2700	350	1585	1489	7,5	207	198	22	25,2
			700	3075	2888	16	192	183		
			1050	4472	4199	24	180	171		
	128902/730CV	3000	350	1608	1511	7,5	210	201		
			700	3120	2930	16	195	186		
			1050	4538	4261	24	182	174		
	128902/740CV	4000	350	1701	1598	7,5	223	212		
			700	3301	3100	16	206	196		
			1050	4801	4508	24	193	184		
	128902/750CV	5000	350	1678	1576	7,5	220	209		
			700	3256	3058	16	203	194		
			1050	4735	4446	24	190	181		
SLM172/50G12	128903/727CV	2700	350	2377	2233	11,2	207	198	33	37,8
			700	4612	4332	23,5	192	183		
			1050	6708	6299	36,5	180	171		
	128903/730CV	3000	350	2412	2266	11,2	210	201		
			700	4680	4395	23,5	195	186		
			1050	6807	6391	36,5	182	174		
	128903/740CV	4000	350	2552	2397	11,2	223	212		
			700	4951	4650	23,5	206	196		
			1050	7202	6762	36,5	193	184		
	128903/750CV	5000	350	2517	2364	11,2	220	209		
			700	4883	4586	23,5	203	194		
			1050	7103	6669	36,5	190	181		
SLM224/50G16	128904/727CV	2700	350	3169	2977	15	207	198	44	50,4
			700	6149	5775	31,4	192	183		
			1050	8944	8398	48,7	180	171		
	128904/730CV	3000	350	3216	3021	15	210	201		
			700	6240	5860	31,4	195	186		
			1050	9076	8522	48,7	182	174		
	128904/740CV	4000	350	3403	3196	15	223	212		
			700	6602	6200	31,4	206	196		
			1050	9602	9016	48,7	193	184		
	128904/750CV	5000	350	3356	3153	15	220	209		
			700	6511	6115	31,4	203	194		
			1050	9471	8892	48,7	190	181		

The mentioned data can have a 10% tolerance - Il dato indicato può avere una tolleranza del 10%.

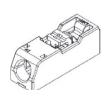
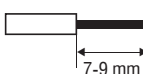
Standard  
connectorInsert/remove wires by slightly  
pressing on push-button.  
Inserire/rimuovere i cavi premendo  
leggermente sul pulsante.Solid conductor - Conduttore rigido  
Fine-stranded conductor - Conduttore flessibile  
Fine-stranded conductor with ferrule with plastic collar -  
Conduttore flessibile con boccia con isolamento in plastica0,2...0,75 mm<sup>2</sup> / 24...18 AWG  
0,2...0,75 mm<sup>2</sup> / 24...18 AWG  
0,25...0,34 mm<sup>2</sup>

## Technical features - Caratteristiche tecniche

**SLM 121/50G8** (Weight/Peso 1,02 oz. / gr. 29 - Pcs/Pezzi 50)

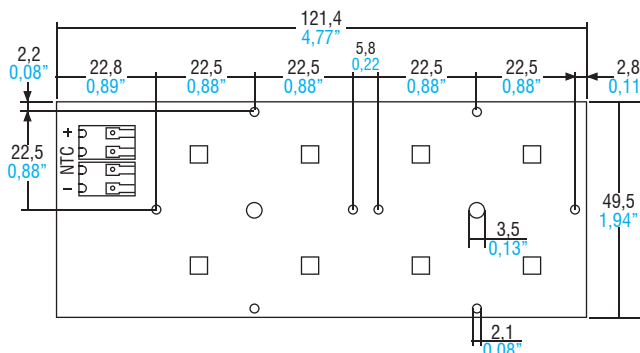
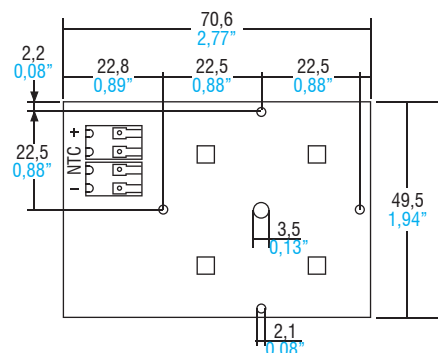

**SLM 224/50G16** (Weight/Peso 1,83 oz. / gr. 52 - Pcs/Pezzi 50)

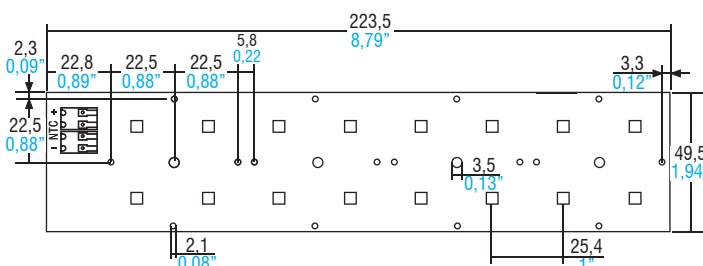
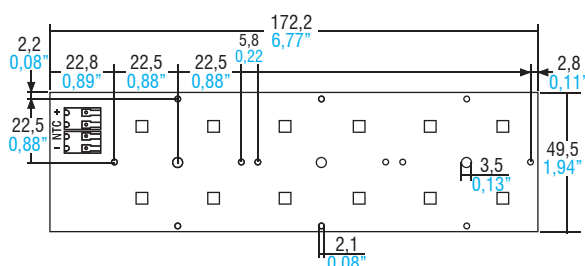

### Zhaga compatible holes

## Wiring Cablaggio



## Accessories - Accessori

## 2x2 OPTICAL MODULES

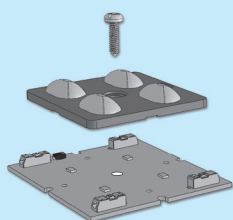

For 128901 - 128902

<b>Thermal pad</b> 70x49 mm / SP 0,23 mm	<b>code</b> 489822290
<b>Thermal pad</b> 121x49 mm / SP 0,23 mm	<b>code</b> 489822291

For 128903 - 128904

<b>Thermal pad</b> 172x49 mm / SP 0,23 mm	<b>code</b> 489822292
<b>Thermal pad</b> 223x49 mm / SP 0,23 mm	<b>code</b> 489822293

For technical details **SEE SECTION 4.** Per dettagli tecnici **VEDI SEZIONE 4.**

**STREET**

<b>Article</b> <b>Articolo</b>	<b>2x2</b> ASYMMETRIC	<b>2x2</b> ELLIPTIC	<b>2x2</b> 120°	<b>2x2</b> TYPE I	<b>2x2</b> TYPE II	<b>2x2</b> TYPE V - 90°	<b>2x2</b> TYPE III - M
<b>Code - Codice</b>	468780051	468780052	468780053	468780054	468780055	468780056	468780057
<b>Article</b> <b>Articolo</b>	<b>2x2</b> TYPE IV	<b>2x2</b> TYPE V - 50°	<b>2x2</b> TYPE II	<b>2x2</b> CROSSWALKS	<b>2x2</b> TYPE I	<b>2x2</b> TYPE IV	<b>2x2</b> CROSSWALKS
<b>Code - Codice</b>	468780058	468780059	468780173	468780238	468780254	468780255	468780239
<b>Article</b> <b>Articolo</b>	<b>2x2</b> TYPE II						
<b>Code - Codice</b>	468780283						

## HIGH-BAY

<b>Article</b> <b>Articolo</b>	<b>2x2</b> 90°	<b>2x2</b> 50°	<b>2x2</b> 9°	<b>2x2</b> 60°	<b>2x2</b> 90°
<b>Code - Codice</b>	468780056	468780059	468780308	468780307	468780296
<b>Article</b> <b>Articolo</b>	<b>2x2</b> 165°	<b>2x2</b> 25°	<b>2x2</b> 40°	<b>2x2</b> 60°	<b>2x2</b> 165°
<b>Code - Codice</b>	468780317	468780299	468780301	468780302	468780318

## Main features

- Highly performant modules, ideal for extensive applications where great accuracy is required.
- Ideal for **industrial, street and outdoor lighting**.
- SELV modules ( $V < 60\text{ V}$ ). Suitable for NON-SELV applications: distance between the voltage area and the board edge  $\geq 2,7\text{ mm}$ .
- Extended lifetime  $> 100.000\text{ h}$ .
- High efficiency: **up to  $223\text{ lm/W}$** .
- Minimum colour tolerance: 3MacAdam (3SDCM).
- Push-in terminal blocks. Easy module fixing with screws.
- Suitable for emergency applications with TCI inverters.
- Only for professional use, not for final end user.

**For additional technical informations please visit our website: [www.tci.it](http://www.tci.it)**

## Caratteristiche principali

- Moduli altamente performanti, ideali per applicazioni estensive dove sia richiesta estrema precisione.
- Moduli ideali per **illuminazione industriale, stradale e da esterno**.
- Moduli SELV (V < 60 V). Idonei per applicazioni NON SELV: distanza tra parte in tensione e bordo scheda  $\geq 2,7$  mm.
- Lifetime esteso > **100.000 h**.
- Elevata efficienza: **fino a 223 lm/W**.
- Minima tolleranza di colore: 3MacAdam (3SDCM).
- Morsetti a innesto rapido. Fissaggio del modulo semplice mediante viti.
- Moduli alimentabili in emergenza con inverter TCI.
- Prodotto ad uso unicamente professionale. Non per impiego da parte dell'utente finale.